

CERTIFICATE OF LOCATION OF GOVERNMENT CORNER

NORTHEAST Corner of Section 10, Township 108N, Range 39W

5th Principal Meridian, State of Minnesota, County of MURRAY

At the corner location shown on the sketch:

On 9/12/2020 found a 8x8x12" STONE DOWN 1.1FT WITH 1" SQUARE IRON BAR ON NORTHWEST SIDE.
DATE

left monument as found lowered monument removed monument (explain)

On _____ placed a _____
DATE

SKETCH OF REFERENCE TIES

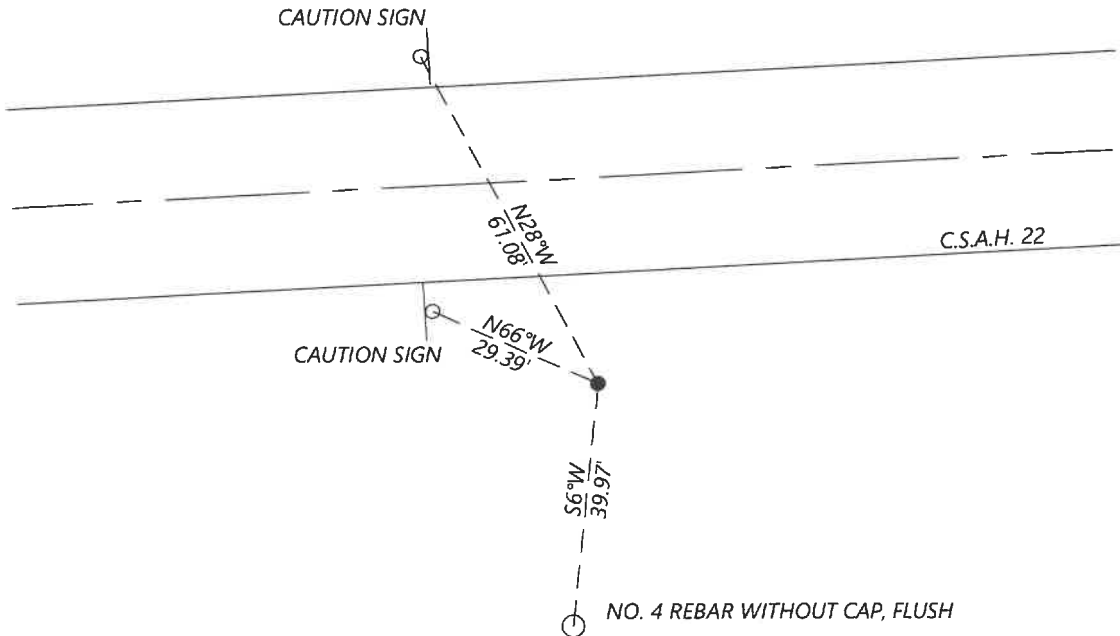

N
↑
N.T.S.

Statement of evidence for this corner location is on back of this page.

I hereby certify that this document was researched and prepared by me or under my direct supervision and that I am a licensed Land Surveyor under the laws of the State of Minnesota.

Signature *[Handwritten Signature]*
 Date 6/17/2021 License No. 45874

Title:

- Land Surveyor Professional Engineer
 County Surveyor County Engineer

OFFICE OF THE COUNTY RECORDER

County of Murray

I hereby certify that this document was filed in the Co.

Recorder's office at _____ M. on the _____ day of _____ A.D. 20 _____

County Recorder *Karen Brown*
 JUN 22 2021
 by _____, Deputy

DOCUMENT NO. _____

Statement of Evidence:

Northeast Corner of Section 10, Township 108 North, Range 39 West, 5th Principal Meridian, Murray County, Minnesota.

1861 July, GLO Notes: Set post in mound.

Undated, Survey record for Section 11 shows the government corner was found. A distance of 2649.2ft is shown to the North Quarter corner.

1963 February, Road plans for CSAH 22 show the corner at station 26+46.0. Scaling off the centerline alignment, it appears the corner is about 33ft off of centerline.

2020 September, Westwood Professional Services searched and found an 8x8x12in stone with a 1x1in square iron rod on the northwest side of the stone, about 34 feet south of the road centerline. I accepted the found stone as the corner and set reference ties.

Analysis of the recovered data, field evidence and survey measurements, indicates that the monument found is the correct perpetuation of this corner. For additional information concerning this corner please contact Westwood Professional Services.